

# COB LED Strip/LED Tape Light Custom Cut to Size (Per Metre / 1m) - No Spotting / Spotless - 8W/m 24V DC Single Colour flexible LED strip Lights custom cut to size

**£10.10**

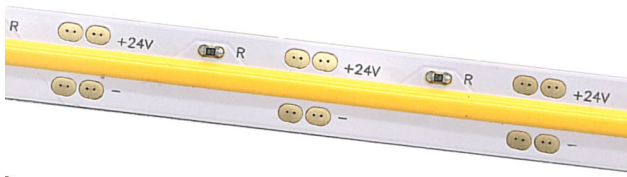

DRIVER SELECTION GUIDE		
Total Length of Strip (m)	Total Load (Watts)	Driver Size (Watts)
1m	8W	20W
2m	16W	20W
3m	24W	30W
4m	32W	30W
5m	40W	40W
6m	48W	40W
7m	56W	60W
8m	64W	60W
9m	72W	80W
10m	80W	80W
11m	88W	100W
12m	96W	100W
13m	104W	120W
14m	112W	120W
15m	120W	150W

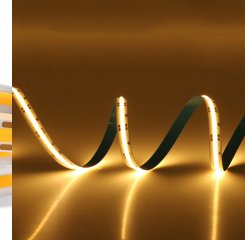
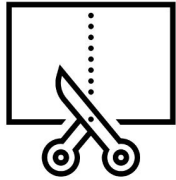
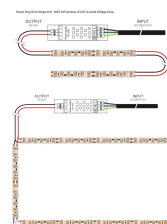
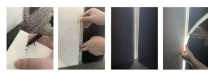
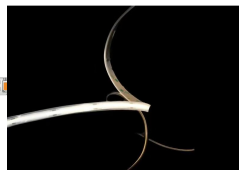
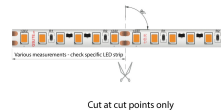
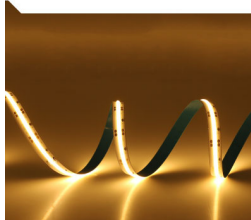

## PRODUCT INFORMATION

LED Type	SMD COB
Warranty	3 Year Warranty
Part L Compliant	No
Dimensions	1m x 10mm
Weight	0.087kg

## TECHNICAL SPECIFICATIONS

Power Consumption	8W/m
Input Voltage	24V DC
Operating Temperature	-20°C to 50°C
Ingress Protection	IP21 / IP65

## LUMEN PERFORMANCE

Beam Angle	120°
LED Quantity	320LED/m

## PRODUCT INFORMATION

## TECHNICAL SPECIFICATIONS

## LUMEN PERFORMANCE

### AVAILABLE OPTIONS

Colour Temperature	Warm White 2700K-3000K Natural White 4000K-4500K Cool White 6500-7000K
3-Hour Emergency Version	No
Built-in Microwave Occupancy Detector	No
1-10V Dimmable	With Compatible Driver
DALI Dimmable	With Compatible Driver
DMX 512 Compatible	Yes (via External DMX Decoder)

**\*\*PLEASE NOTE THIS KIT CONTAINS LED STRIP WHICH IS EXTREMELY FRAGILE AND REQUIRES PROFESSIONAL INSTALLATION. PRODUCT SHOULD BE ORDERED/INSTALLED BY A QUALIFIED ELECTRICIAN EXPERIENCED WITH LED STRIP/LOW VOLTAGE SYSTEMS.\*\***

**\*\*1M, 2M, 3M AND 4M ARE CUT TO SIZE AND SUPPLIED WITH 1 x NUMBER [WIRED END CONNECTOR](#) FOR THE CUSTOMER TO INSTALL/CONNECT\*\***

**We sell it in [complete 5m rolls](#) here.**

Power Strip from Single end - MAX 5M Sections of LED to avoid Voltage Drop

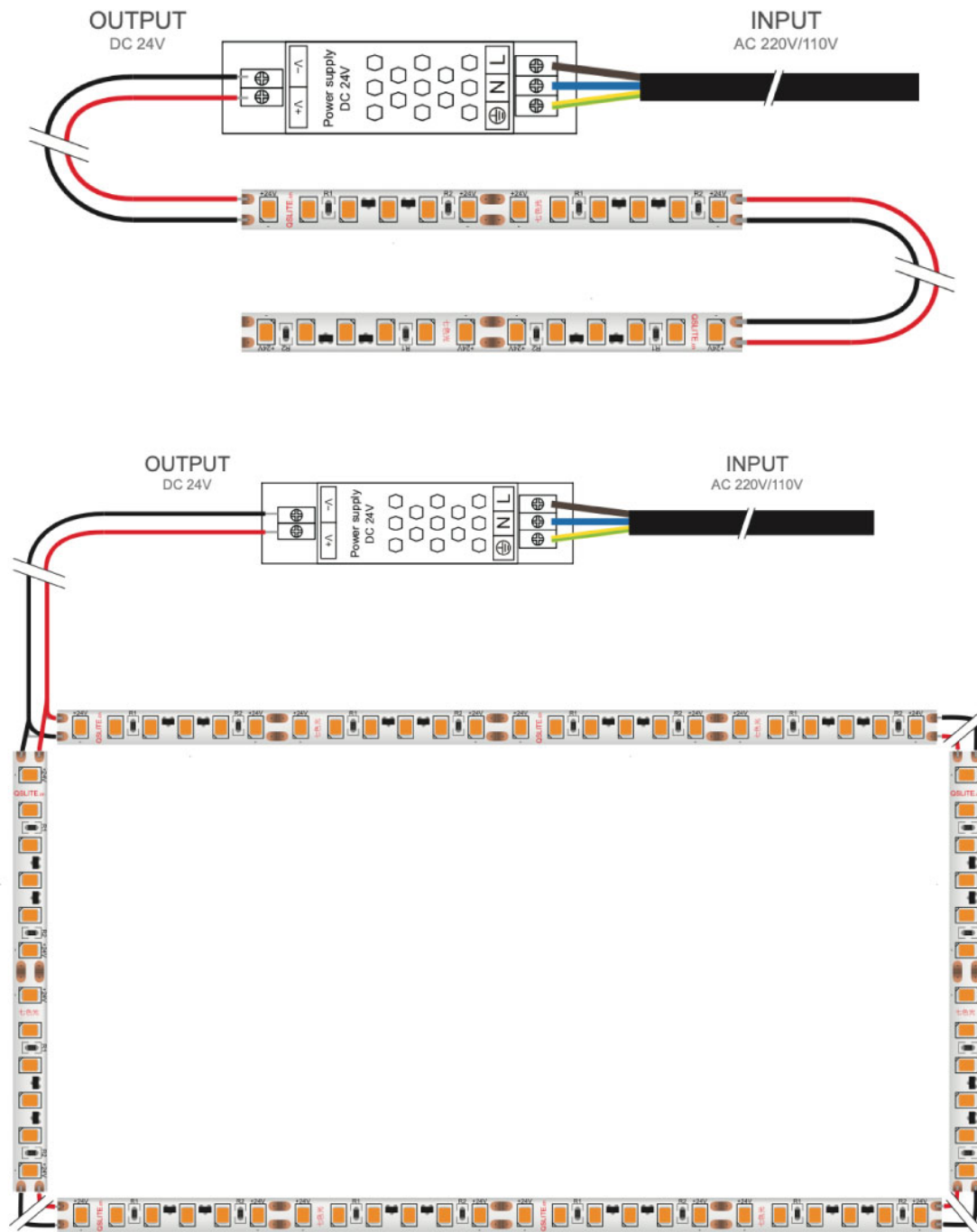

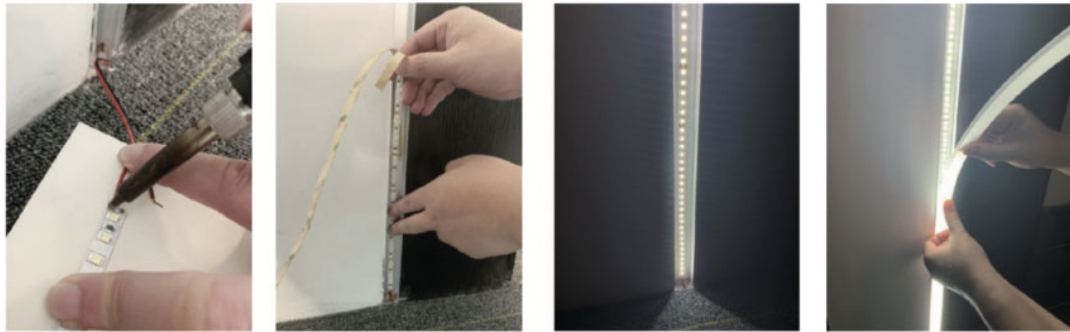

On some models, clip on connectors are available\*

*Note - The IP65 version of this product doesn't fit in profile types LSTAL-FR AND LSTAL-SL,. If you require this profile with the IP65 waterproof version, please order the clip in diffuser*

Order LED Strip by the metre, custom cut to length to the nearest 1m complete with pre-soldered cable for simple installation straight to your power supply or controller + specify the length of cable required from 1m to 10m. LED Strip is cut to the nearest metre ie. if you require 3.7m, select 4m, you can then simply cut with a pair of scissors to the desired length on site as the LED tape has cut points every 5-10cm depending on the type. You can also specify the length of the cable size from 1 - 10m. If you require multiple cuts, add each to cart individually & remember to check the cart before placing the order as once into production your order CANNOT be changed. **Please note - once custom cut, the items are non refundable.**

[DOWNLOAD LED STRIP LIGHT LED TAPE LIGHT INSTRUCTIONS - HOW TO INSTALL LED STRIP GUIDE / MANUAL](#)

#### DRIVER SELECTION GUIDE

Total Length of Strip (m)	Total Load (Watts)	Driver Size (Watts)*
1m	8W	20W
2m	16W	20W
3m	24W	30W
4m	32W	60W
5m	40W	60W
8m	64W	100W
10m	80W	100W
12m	96W	100W
15m	120W	150W

#### Do you offer a 'cut-to-size' service?

*Yes, see above options for adding on custom length cut to the nearest m ie. if you require 3.7m, select 4m, you can then simply cut to the desired length on site with a pair of scissors as the LED tape is cuttable every 5-10cm depending on the type. You can also specify the length of the cable size known as 'tails'; from 1 - 10m. If you require multiple cuts, add each to cart individually. **Please note - once custom cut, the items are non refundable.***

#### Does the LED Tape come with Aluminium Profile?

*We sell each item individually, so this product page is for the led tape/led strip only. Check out relate products below for our range of [aluminium led profile](#) here.*

#### Can I cut the aluminium LED tape?

*Yes, it can be cut with a pair of scissors or electrical cutters at specified points.*

#### Do you have corner pieces/how do I go around corners?

*We don't do corner pieces for our LED Strip. For going around 90° corners, you would need to cut and solder a cable connection join.*

**Do you have joining pieces/ how do I join LED aluminium profile?**

We don't do joining pieces for any of our led strip as generally it shouldn't be installed in single runs longer than 10m due to voltage drop to obtain a continuous appearance. If you do have to join a section or 2 off-cuts, you would need to cut and solder a cable connection join or use a [led strip connector](#). NOTE - LED strip connectors may not fit in all LED profiles please check prior to ordering.

**What colours is the LED strip available in?**

As standard, we stock 3 whites:

- Warm White 2700-3000K
- Natural White - 4000K
- Cool white - 6500-7000K

**What lengths does LED strip come in?**

We typically stock all of our LED Strip in 5m rolls and by the m/cut to size.

**Is this waterproof? Can it be used outdoors or in bathrooms?**

The LED strip itself is available in IP21 non-waterproof & IP65, waterproof / outdoor use. If outdoor or in wet locations, you would need to use suitable waterproof IP rated LED tape with your installation denoted IP65/waterproof. Note IP65 is splash-proof and not submergible.

**How do I stop the LEDS spotting/dot effect?**

Using a continuous spotless / non spotting LED Strip such as this one [no spotting / no dotting spotless LED strip / LED tape light](#)

**What size LED tape / LED strip fits in our LED aluminium profiles?**

All of our range of LED strip/led tape fits in any of our profile, so rest assured when buying both LED tape and LED profile from us, your products are compatible.