

Solar LED Street Light 25W/50W/75W- Split Integrated Solar PV Street Exterior Light c/w Built In 3-in-1 Solar Panel & Lithium LiFePO4 Battery

£939.00 £831.45

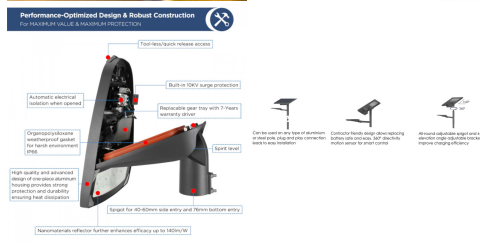

SOLAR STREET LIGHT



Dimensions and mounting

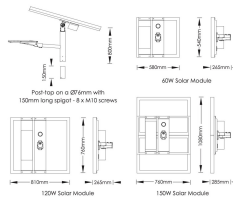

Control Mode

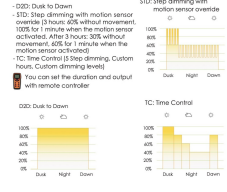

INSTALLATION INSTRUCTIONS:

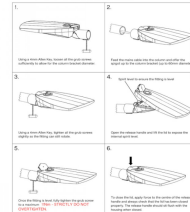

PRODUCT INFORMATION

| | |
|------------------|--|
| LED Type | SMD3030 LEDs |
| Warranty | 5 Year |
| Part L Compliant | Yes |
| Dimensions | LSTPSS-010 / 20 666mm x 289mm x 104mm LSTPSS-030 / 40 832mm x 354mm x 115mm |
| Weight | LSTSSL-025 / 4,500lm / 17.8kg LSTSSL-050 / 9,000lm / 21.2kg LSTSSL-075 / 13,500lm / 25.8kg |

TECHNICAL SPECIFICATIONS

| | |
|-------------------|--|
| Power Consumption | LSTSSL-025 / 4,500lm / 12.8V/30Ah LSTSSL-050 / 9,000lm / 12.8V/60Ah LSTSSL-075 / 13,500lm / 12.8V/60Ah |
|-------------------|--|

| | |
|-----------------------|---------------|
| Power Factor | >0.96 |
| Operating Temperature | -20°C to 50°C |
| L70 Rated Lifetime | +70,000hrs |
| Ingress Protection | IP66 |

LUMEN PERFORMANCE

| | |
|------------------------------|--|
| Luminous Efficiency | 180lm/W |
| Beam Angle | 150° x 80° |
| CRI (Colour Rendering Index) | >80Ra |
| Lumen Output | LSTSSL-025 / 4,500lm / 12.8V/30Ah LSTSSL-050 / 9,000lm / 12.8V/60Ah LSTSSL-075 / 13,500lm / 12.8V/60Ah |

AVAILABLE OPTIONS

| | |
|--------------------|--------------------------|
| Colour Temperature | Natural White 4000-4500K |
|--------------------|--------------------------|

PRODUCT INFORMATION

TECHNICAL SPECIFICATIONS

LUMEN PERFORMANCE

AVAILABLE OPTIONS

| | |
|---------------------------------------|----------------------|
| 3-Hour Emergency Version | No |
| Built-in Microwave Occupancy Detector | Available on Request |
| 1-10V Dimmable | Available on Request |
| DALI Dimmable | Available on Request |

Solar LED Street Light 25W/50W/75W- Split Integrated Solar PV Street Exterior Light c/w Built In 3-in-1 Solar Panel & Lithium LiFePO4 Battery

For Optimum Results, install on a 15° angle to the sun. If facing away from the sun then mount horizontally ie. Not facing away from the sun/shaded. Do not install in shaded areas - require direct sunlight.

The split integrated smart solar street luminaire is a reliable and robust stand-alone solar lighting solution suitable for pedestrian, bicycle paths, and parking lot lighting. There is no trenching and grid cabling work on site. Modular design, plug and play connection lead to easy installation. It offers full range of power and lumen packages, which will well satisfy different applications.

It enjoys a smart and unique design together with the best components available on the market. Using LiFePo4 battery, MPPT controller make it the most powerful and reliable solar street light solution. High-pressure die cast aluminium housing finished with integrated Mono-Si solar panel which has 25 years anticipated life span, it provides long lasting and optimised illumination with 100% energy savings. 360°adjustable spigot and ±60°elevation angle adjustable bracket allow the solar panel freely adjusted according to the best sunshine direction, greatly improve charging efficiency.

Smart control with built-in motion sensor and programmable time dimming offer longer discharge time and optimum performance. Contractor friendly design allows replacing battery safe and easy. This luminaire also complies with the dark sky requirement with no upward lighting pollution.



Can be used on any type of aluminium or steel pole, plug and play connection leads to easy installation



Contractor friendly design allows replacing battery safe and easy, 360° directivity motion sensor for smart control



All-round adjustable spigot and $\pm 60^\circ$ elevation angle adjustable bracket improve charging efficiency

Product information

Mono-crystalline high-efficiency cells solar module / Lithium Iron Phosphate (LiFePO4) battery / Electronic protection battery management system / MPPT solar charge controller / UKCA, CE & RoHS international standards / Environmentally friendly & part recyclable: no mercury or other hazardous materials used / Integrated temperature & motion sensors / Robust aluminium structure with light weight / Complies with EN60598

Control Mode

- D2D: Dusk to Dawn
- STD: Step dimming with motion sensor override (3 hours: 60% without movement, 100% for 1 minute when the motion sensor activated. After 3 hours: 30% without movement, 60% for 1 minute when the motion sensor activated)
- TC: Time Control (5 Step dimming, Custom hours, Custom dimming levels)



You can set the duration and output with remote controller

STD: Step dimming with motion sensor override

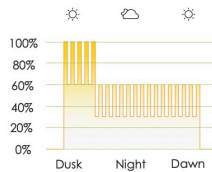

D2D: Dusk to Dawn

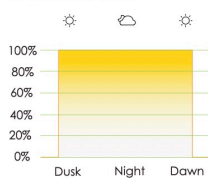

TC: Time Control

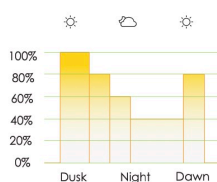

Beam Angle: Optic SR (Standard Road) Luminous Efficacy: 180lm/W

Color Rendering Index: 80Ra

LED Type: LM80 3030LEDs

Solar Module: Mono-crystalline
(25 years of anticipated lifespan)

Battery: LiFePO4 (8 years of anticipated lifespan) System Design: 12/24 VDC

Solar Charge Controller: MPPT

Charging Time: 5-6 hours

Control Mode: D2D (Dusk to Dawn) / STD (Step Dimming with Motion Sensor Override) / TC (Time Control)

Operating Temperature: -10°C to 50°C Mounting Option: Post-top Slip-over - Ø76mm Mounting Height: 3-8m

Color Temperature: Neutral White 4000K

(Others available on request)

† Calculations are done with the 3 hours of Peak Sun Hour
*

Calculations are done with 12 hours of operation per day, detection of movement is 5 times per hour

Autonomy and Operation time calculations are only indicative and will depend on several variable factors

Note: whilst all units are designed to have 2 day autonomy on a full charge, as a supplier/manufacturee we have little control over the weather/sun and this prolonged periods of no sun, full cloud coverage or installed in shade will ultimately prevent the battery from full charging. If you are in need of an installation which is guaranteed 365 days a year, we recommend you opt for a mains installation to avoid any doubt.