

LED Street Light with Elexon UMSUG Codes for Unmetered supplies - 30w - 3-6M Column Street Lighting Fixture Flicker Free

£98.40

4,200lm

30W
Replaces
35W SOX



LED Premium Street Light DIMENSIONS

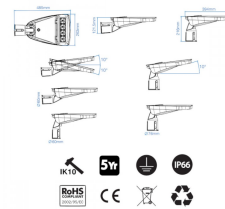

Performance-Optimized Design & Robust Construction



PHOTOCELL ENABLED

FOR UP TO 80% SAVINGS ON ELECTRICITY



DURABLE, ROBUST AND DEPENDABLE LONG LASTING PERFORMANCE



24/7 CUSTOMER SUPPORT



INSTALLATION INSTRUCTIONS:

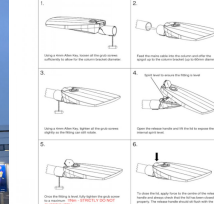

INSTALLATION INSTRUCTIONS:

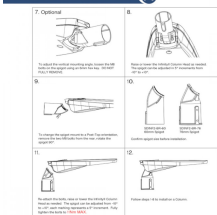

Free Lighting Design Service



PRODUCT INFORMATION

LED Type	SMD3030 LEDs
Warranty	5 Year
Part L Compliant	Yes
Dimensions	617mm x 212mm x 118mm
Weight	3.45kg
Socket Type	Optional 3 pin NEMA Socket
Equivalent to	35 SOX

TECHNICAL SPECIFICATIONS

Power Consumption	30W
Input Voltage	100-280V AC
Power Factor	>0.96
Operating Temperature	-20°C to 50°C
L70 Rated Lifetime	+100,000hrs
Ingress Protection	IP66

PRODUCT INFORMATION

TECHNICAL SPECIFICATIONS

LUMEN PERFORMANCE

Luminous Efficiency	140lm/W
Beam Angle	150° x 80°
CRI (Colour Rendering Index)	>80Ra
Lumen Output	4,200lm

AVAILABLE OPTIONS

Colour Temperature	Warm White 3000K / Natural white 4000K
3-Hour Emergency Version	No
Built-in Microwave Occupancy Detector	No
1-10V Dimmable	Available on Request
DALI Dimmable	Available on Request

LED Street Light with Elexon UMSUG Codes for Unmetered supplies - 30w - 3-6M Column Street Lighting Fixture Flicker Free

Luminaire designed for column/post mounting at heights of 4 - 16m, with a range of sizes across 30W - 240W (4,200-33,000lm), IP66 design for exterior environments, with a low profile, sleek silver anodised aluminium body for harsh weather environments, Premium Street light is for urban applications such as car-parks, pathways and pedestrian areas. PMMA optic lens ensures a high degree of uniformity across a range of spaces and reduced light spillage, thus further enhancing this 140lm/W luminaire to give optimum lux levels through out. Furthermore the Premium Street light is compatible with standard mains photocells. Additional benefits include 100,000 hours maintenance free performance, with no-tools/quick release access to the internal control gear for installation. Unit available with either 60mm or 76mm entry bracket for both bottom & side-entry hence universally compatible. Angle of illumination can be adjusted around 10° for increased spread. Slate Grey RAL 7015.

[DOWNLOAD PRODUCT INSTALLATION MANUAL / GUIDE](#)