

**6ft LED Strip Light - 1800mm Non-corrosive IP65 Twin/180cm [1.8m] Vapour-proof / Weatherproof Batten**

**£41.84**

**9,100lm**

**65W**  
**6FT**  
**1800mm**

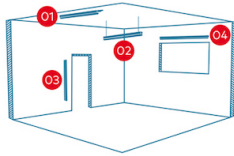
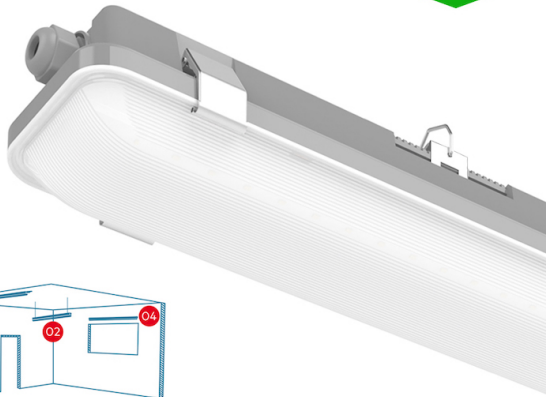

**DURABLE & RELIABLE CONSTRUCTION**

**STAINLESS STEEL CLIPS & PC BODY**

**FROSTED DIFFUSER**  
allows soft, non-glare light, provides bright and uniform coverage



Stainless Steel Bracket / W Suspension Hook

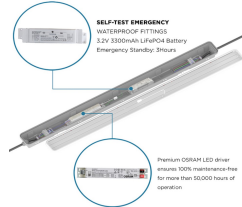

**SELF-TEST EMERGENCY WATERPROOF FITTINGS**  
2xV 3000mAh Lithium Battery  
Emergency Standby: 3 Hours

Premium OSRAM LED Driver  
ensures 100% maintenance free for more than 50,000 hours of operation

**IP65 WATER & DUST PROOF RATING**

Can be used in damp areas like parking lots, workshops, and similar environment constantly exposed to moisture and dust

**IP65 LED Vapour-proof Fitting**

Easy Installation and Maintenance

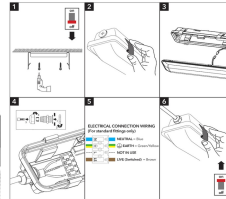

**LED VAPOUR-PROOF FITTING**

IP65 Water & Dust Proof



SUITABLE FOR MULTIPLE APPLICATIONS



**DURABLE & RELIABLE CONSTRUCTION**

**STAINLESS STEEL CLIPS & PC BODY**

**FROSTED DIFFUSER**  
allows soft, non-glare light, provides bright and uniform coverage



Stainless Steel Bracket / W Suspension Hook

**VERSATILE MOUNTING OPTIONS**

Perfect Deployment for Fluorescence

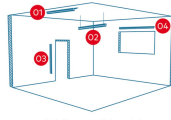

01 Ceiling 02 Vertical wall 03 Suspended 04 Horizontal wall



**IP65 WATER & DUST PROOF RATING**

Can be used in damp areas like parking lots, workshops, and similar environment constantly exposed to moisture and dust

**PRODUCT INFORMATION**

LED Type	SMD2835 LEDs
Warranty	5 Year
Part L Compliant	Yes
Dimensions	1840mm x 100mm x 84mm
Weight	3.2kg
Equivalent to	1800mm Twin 58W T8

**TECHNICAL SPECIFICATIONS**

Power Consumption	65W
Input Voltage	220-280V AC
Power Factor	>0.95
Operating Temperature	-20°C to 40°C
L70 Rated Lifetime	+50,000hrs
Ingress Protection	IP65
Emergency Battery Type	LiFePO4 3300Mah Lithium Ion c/w Self Test

**LUMEN PERFORMANCE**

Luminous Efficiency	120lm/W
Beam Angle	120°
CRI (Colour Rendering Index)	>75
Lumen Output	9,100lm

**AVAILABLE OPTIONS**

Colour Temperature	Natural White 4000K
--------------------	---------------------

## PRODUCT INFORMATION

## TECHNICAL SPECIFICATIONS

## LUMEN PERFORMANCE

### AVAILABLE OPTIONS

3-Hour Emergency Version    Yes

DMX 512 Compatible        No

6ft / 1800mm [1.8m] Twin LED Strip Light - Osram® Driver

### **LiFePO4 Lithium Ion Emergency Battery - Environmentally friendly, fully recyclable**

A revolutionary LED replacement to replace complete non-corrosive fluorescent tube fittings in 1800mm / 6ft twin variety - 65W / 9,100lm. With direct illumination technology, prove advantageous over both conventional fluorescents and LED tube counterparts in terms of industry leading efficacy: 120lm/W. Hence an L70 rated lifetime of 50,000+ hour and simple installation, this unit has proved to be the specifiers number one choice being deemed truly 'fit-and-forget'. Wide demand throughout commercial and industrial sectors, namely workshops, high-humidity areas and even outbuildings use being IP65 weather-proof. Toughened polycarbonate diffuser for uniform lumen output with robust PC base. Unit comes complete with stainless steel side clips, detachable hinged tray for ease of install, fixing brackets and M20 x 1.5 IP65 cable gland. Options of 4ft/1200mm, 5ft/1500mm & 6ft/1800mm. M3/NM3 emergency version includes internal built in 3-hour maintained emergency pack.