

\* Maximum design head load based on wind loading region with orientation of bracket/ luminaire(s) being on same plane as door

Maximum Loading including Bracket		
Wind Loading Region	Terrain Category	Weight/Area
Extra Light	II	55kg/0.48m <sup>2</sup>
	III	60kg/0.63m <sup>2</sup>
Light	II	40kg/0.42m <sup>2</sup>
	III	60kg/0.53m <sup>2</sup>
Medium	II	38kg/0.38m <sup>2</sup>
	III	50kg/0.49m <sup>2</sup>
Heavy	II	35kg/0.34m <sup>2</sup>
	III	45kg/0.44m <sup>2</sup>
Extra Heavy	II	30kg/0.25m <sup>2</sup>
	III	34kg/0.33m <sup>2</sup>

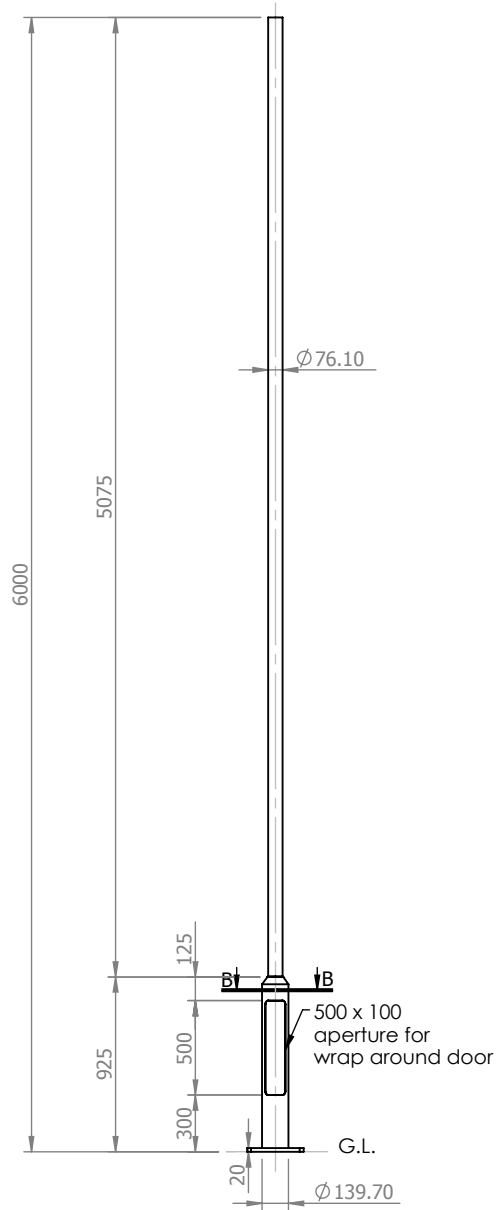
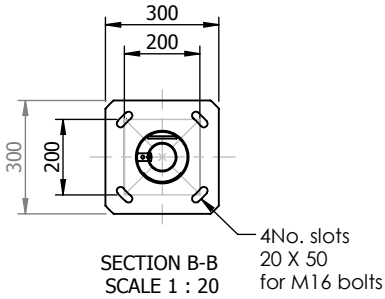

2012 © Copyright

**SEDNA**<sup>®</sup>  
g h t i n g

Revisions		
Rev.	Description	Date
1	Loading Table Added	21/11/2013

Sedna Lighting Ltd  
Unit M2 Southpoint,  
Cardiff,  
CF10 4LQ  
: 02920 099 092  
F: 02920 099 091  
info@sedna.lighting  
www.sedna.lighting

**Title**

6 Metre Tubular Post Top Column

**Drng No.** 28779-1

Scale:1:40  
Sheet 1 of 1

Drawn By: MJB

Chk'd: MB

Ref. SDCOL-6M-76MM-FPLT16

Contract:

Customer:

Date: 07/11/12

**Notes**

All dimensions in millimetres unless stated otherwise.

When Multiple views are shown 3rd Angle Projection is assumed.